

**Infrapalm
IHPA**



GB ... 3

DE ... 6

FR ... 11

NL ... 14

ASSEMBLY AND OPERATING INSTRUCTIONS

Dear Customer, please read the following information carefully before using the appliance for the first time for your own safety and to ensure correct use.

Safety information

These instructions belong to the appliance and must be kept in a safe place. If changing owners, they should be surrendered to the new owner.

- The appliance should be used only in the way described in this instruction manual and may be used outside, even in wet conditions.
- The appliance is not intended for use in animal farming and rearing.
- Do not use the appliance in flammable and combustible atmospheres.
- Connect the appliance only to an alternating current. Voltage as specified on the rating plate.
- The appliance should be connected to the mains by a qualified electrician and according to current and local electrical regulations.
- The manufacturer has provided an appropriate supply cable with this appliance.
- When installing, ensure it is suitably connected to a power point that can be disconnected on all poles.
- The supply cable should be laid out in such a way to prevent it being damaged or tripped over.
- In case the cable is damaged during operation the unit should be disconnected from the power and a qualified electrician called to make the necessary repairs.
- The guarantee and any liability of the producer will be invalid in case of damage caused by improper use, improper assembly or lack of compliance with safety regulations.
- If the appliance is installed in an area where there is a risk of high winds, public events, children playing etc., the base of the appliance must be anchored to the ground with screws or bolts - \varnothing 8x120.

- After initially switching on the appliance or following periods of non use, there may be a burning smell.
- Never touch the heater elements during operation or for at least 20 minutes after switching off.

Cleaning

Disconnect the equipment from the power supply system before cleaning any part of this apparatus.

- Do not use abrasive or caustic cleaning agents.
- Clean with soft, moistened lint.
- Do not touch the heater lamps with bare fingers since the deposited grease can cause premature failure.
- If it happens, clean the quartz with a soft cloth moistened with alcohol. Do not use denatured or spirit salicylic.

After sales service

All repairs must be carried out by a person having adequate knowledge and qualifications. Any repairs carried out by unqualified personnel may cause loss of warranty.

Unpacking the heater

Before unpacking please check that the packaging has not been damaged during transport. If so, check for any visible damage and inform your supplier. After assembly, the packaging should be removed according to local regulations.

Note

Non-professional installation or repairs constitutes danger for the users!

Assembly of the heater

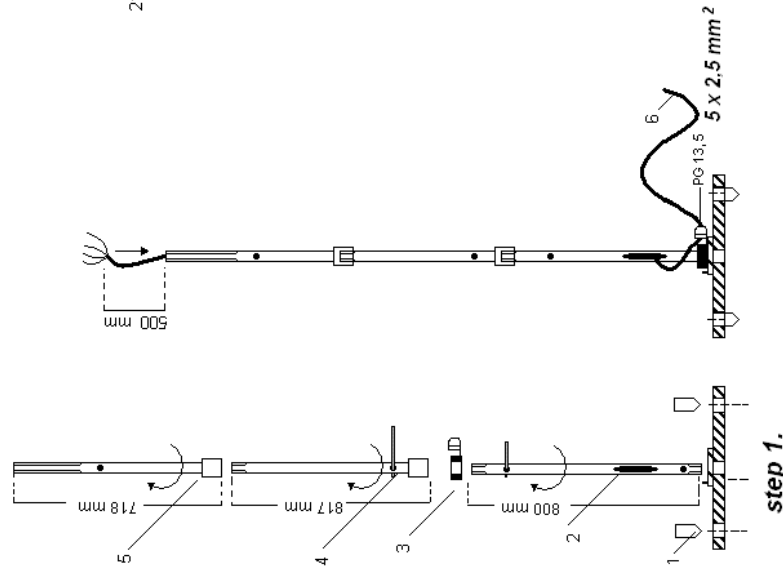

step 1.

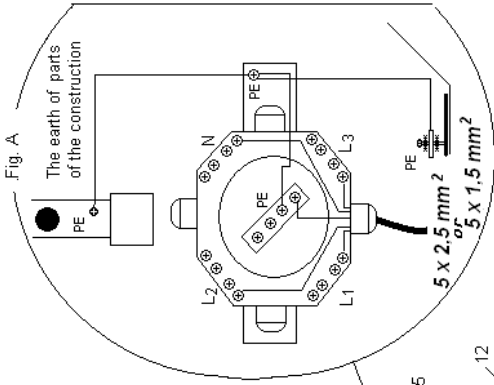

specific key for screw element No 14

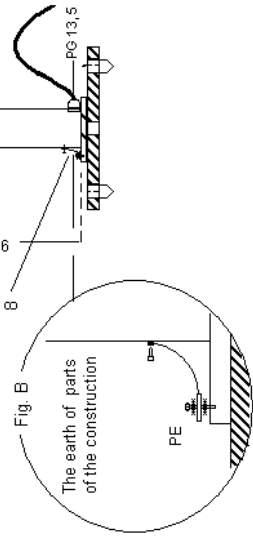
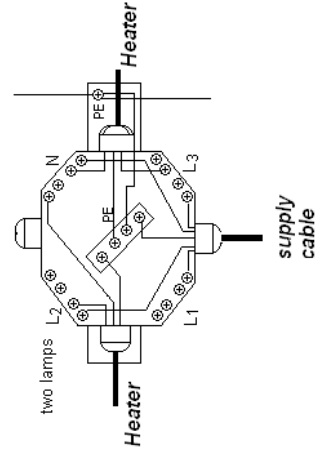
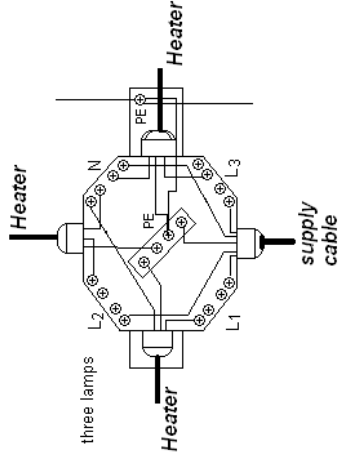
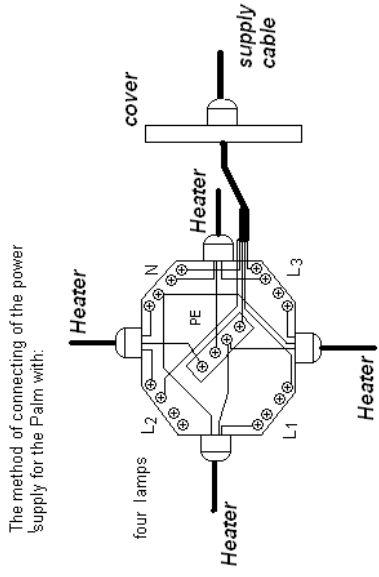

A: The cast-iron base

Lay the cast-iron base on a horizontal plane. Screw the six leveling bolts (1) into the holes in the base with the use of a hexagon socket wrench. If the base is to be fixed to the ground after assembly, use only three leveling bolts interspersed with fixing bolts.

B: Attaching the steel tubes to the base

Screw steel tube (2) into the base and tighten. (A steel bar is provided for this purpose.) Slide the right-angled steel cable anchorage (3) onto the steel tube ensuring the angle is facing upwards. Do not add the plastic cable gland (PG 13,5) at this stage. Screw on the other two poles (4) and (5) and tighten.

C: Fitting the supply cable* Three phase**

Feed the supply cable (6) from the top to the base until it exits by a few centimeters. Dismantle the plastic cable gland and add the inner nut to the supply cable and then feed the cable through the hole of the steel anchorage (3). Pull through until 50cm of supply cable remains at the top. Feed on the rubber seal to the cable, followed by the main part of the cable gland and locking nut. Assemble and tighten.
 * On some versions, the feed cable and junction box may already be connected. This is for guidance only and should be dismantled before attempting to install the cable.
 ** If monophase is required, consult with your electrician.

D: Aluminum outer casing and heater and cable casing

Fit the 900mm casing (7) with the earth cable (8) attached to the base. Follow with ring (9), 700mm casing (10), ring (11), 525mm casing (12), ring (13). Screw on flange (14) with supplied key until the outer casing is locked tightly into place. Add the heater support frame (15) and screw it down tightly with one of the two brass nuts (16). Slide on the flange (17) followed by the second brass nut (18), BUT DO NOT TIGHTEN.

E: Heater and junction box installation

Carefully attach each heater (21) to the frame with the supplied nuts and bolts, ensuring the end of each heater arm is engaged under the loose flange (17). The brass nut can now be gradually tightened until the heater angles are as required. Recommended angle 45°. Feed the supply cable through the junction box pole (19-20). Screw on ensuring the cable does not twist.

F: Electrical connections

This work should be completed by a qualified electrician. Ensure there is no connection to the electricity supply at this stage. Firstly connect the supply cable to the junction box (Fig A) neutral to the brass-colored connector marked N phases to each steel phase connector. (8kW models, two phases can be added to the connector with the strongest voltage rating.) earth to the central connector ensuring a circuit to the outer steel frame of the junction box and finally connecting to the central steel post. Feed each heater cable through the steel spring grommets into the junction box, making the appropriate connections. Finally check all electrical connections are tight, replace and screw on junction box cover. Install the globe cover (22) and fix in place with washer (23) and chrome-plated bolt (24).

Now connect to the appropriate electricity supply. The recommended three phase cross-section of cables and power protections (fuse) for the heater.

RCA heaters Total power in kW	Fuse Time-lag „C”	Cable cross section in mm ² (length up to 10 m)
4,0	10A	1,5
6,0	10A	1,5
8,0	10A	2,5

Main office

Frico AB
Box 102
SE-433 22 Partille
Sweden

Tel: +46 31 336 86 00

mailbox@frico.se
www.frico.se

**For latest updated information and information
about your local contact: www.frico.se**

